

ICARO

Aircraft Warning Lights

GENERAL CATALOGUE

ICARO

 **SIRENA**

**MORE THAN
BRIGHT IDEAS**



INDEX

INTRODUCTION	2
---------------------------	----------

PRODUCTS

AWL 810/AB	4
AWL 810/AB TWIN	5
AWL 864/BC	6
AWL 864/BC TWIN	7
AWL 865.866/A	8
AWL 864+865.866/BC+A	9
AWL 856.857/AB	10
HELIX	11

SUGGESTED CONFIGURATIONS	12
---------------------------------------	-----------

ACCESSORIES	16
--------------------------	-----------

INTRODUCTION



Sirena designs, engineers and manufactures signaling devices since 1974. From Industrial Signaling Devices to Evacuation Systems, through Aircraft Warning Lights and Automation Devices, our expertise allows to deliver Customers with the highest quality signaling devices available on today's market.

With 40 years of intense know-how and a presence in over 60 countries worldwide, Sirena is the best choice when it comes to satisfying your signaling needs.

ICARO is Sirena's Aircraft Warning Lights range. Engineered entirely on LED base, **ICARO's** Low, Medium and High intensity devices are one of the best products available today. High performances, easy installation and virtually zero maintenance, allow Customers and Installers to add considerable value to their projects. All devices are ICAO and FAA certified as well as CE marked.

Our expert Team will guide you to the right choice and will help you to determine the best and most cost efficient solution for your projects.

With a complete range of devices (Low Intensity Type A and B, Medium Intensity Type A, B and C and High Intensity Type A and B), **ICARO** is the complete solution you are looking for.

Sirena is ISO 9001, 14001 and 18001 certified.

HIGH INTENSITY

High Intensity Aircraft Warning Lights compliant to ICAO Type A, B and FAA L-856, L-857 regulations.

100% LED based, these devices offer a white light with a maximum intensity of 200.000 Cd satisfying the most demanding applications.

Typically installed on structures over 150 meters, high intensity devices are used for day and twilight marking.

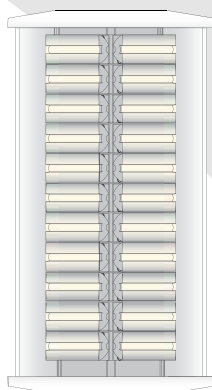

MEDIUM INTENSITY

Medium Intensity Aircraft Warning Lights compliant to ICAO Type A, B, C and FAA L-864, L-865, L-866 regulations.

100% LED based, these devices offer a white/red light with a maximum intensity of 20.000 Cd satisfying the most demanding applications.

Typically installed on structures over 45 meters, medium intensity devices are used for day, twilight and night marking.

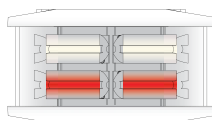

LOW INTENSITY

Low Intensity Aircraft Warning Lights compliant to ICAO Type A, B and FAA L-810 regulations.

100% LED based, these devices offer a red light with a minimum intensity of 32 Cd satisfying the most common applications.

Typically installed on structures below 45 meters and as interim devices on taller structures, low intensity devices are used for night marking only.

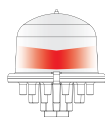

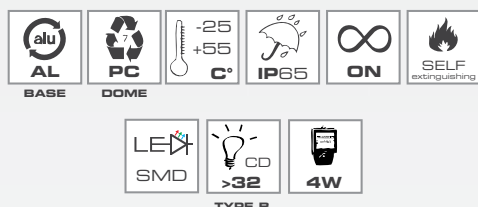

CERTIFICATIONS



ICAO International Standards and Recommended Practices:
Aerodromes - Annex 14 Volume 1, 4th Edition, November 2004
Chapter 6

FAA Advisor Circular AC150/5345-43F

TYPICAL APPLICATIONS

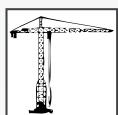

CRANES



PYLONS

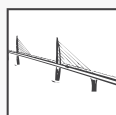

INFRA-
STRUCTURES



WIND
TURBINES



BUILDINGS



WATER
TANKS



CHIMNEYS



AIRPORTS

AWL 810/AB | PART NO

BEACON (24V DC)
PSU (110/240V AC)
SIDE BRACKET

51010
51011
51013

LOW INTENSITY AIRCRAFT WARNING LIGHT

Low intensity aircraft warning light engineered according to ICAO Low Intensity Type A/B and FAA L-810 regulations.

With a lightweight heatsink base, this device is the ideal solution for an efficient and long lasting quality obstruction beacon.

Provided with a red steady light, its optical reflector guarantees a 360° horizontal beam radiation and a vertical beam between +6° and +10°.

The LED circuit guarantees a long product life estimated in over 10 years, as well as low consumption (1/10 when compared to incandescent bulbs).

KEY CHARACTERISTICS

LED technology

Product life >10 years

Low consumption

Stabilized light output

INSTALLATION

Pole mounting | Direct (3/4" NPT-F)

Side mounting | To side walls, side poles or side structures using the accessory "Side bracket"

DRAWINGS, DIMENSIONS AND WEIGHTS

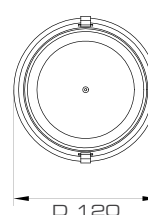
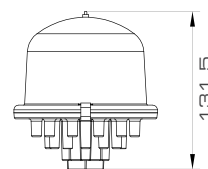

ICARO



**TWIN
BACK-UP
CIRCUIT
INCLUDED**

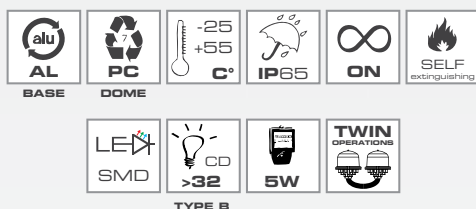

CERTIFICATIONS



ICAO International Standards and Recommended Practices:
Aerodromes - Annex 14 Volume 1, 4th Edition, November 2004
Chapter 6

FAA Advisor Circular AC150/5345-43F

TYPICAL APPLICATIONS

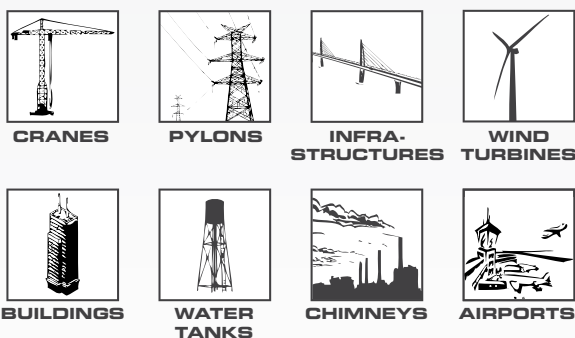

AWL 810/AB TWIN | PART NO

BEACON (24V DC)	51014
PSU (110/240V AC)	51011
SIDE BRACKET	51013

TWIN LOW INTENSITY AIRCRAFT WARNING LIGHT

Low intensity aircraft warning light engineered according to ICAO Low Intensity Type A/B and FAA L-810 regulations.

With a lightweight heatsink base, this device is the ideal solution for an efficient and long lasting quality obstruction beacon.

Provided with a red steady light, its optical reflector guarantees a 360° horizontal beam radiation and a vertical beam between +6° and +10°.

The LED circuit guarantees a long product life estimated in over 10 years, as well as low consumption (1/10 when compared to incandescent bulbs).

The device is equipped with two separate LED circuits and, thanks to the current sensor installed on board, it automatically switches to the secondary circuit when main fails, with the possibility of sending an alarm signal.

KEY CHARACTERISTICS

LED technology

Product life >10 years

Low consumption

Stabilized light output

Twin operations with the same device
(back-up circuit included)

Crepuscular sensor for automated operations

INSTALLATION

Pole mounting | Direct (3/4" NPT-F)

Side mounting | To side walls, side poles or side structures using the accessory "Side bracket"

DRAWINGS, DIMENSIONS AND WEIGHTS

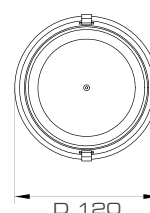
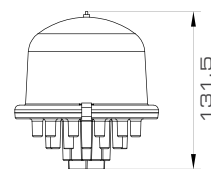

ICARO

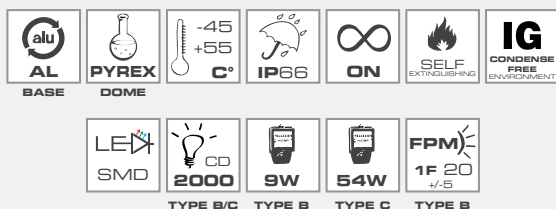

CERTIFICATIONS



ICAO International Standards and Recommended Practices:
Aerodromes - Annex 14 Volume 1, 4th Edition, November 2004
Chapter 6

FAA Advisor Circular AC150/5345-43F

TYPICAL APPLICATIONS

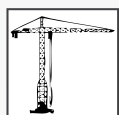

CRANES

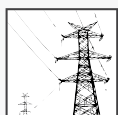

PYLONS

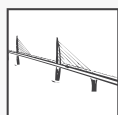

INFRA-
STRUCTURES



WIND
TURBINES



BUILDINGS



WATER
TANKS



CHIMNEYS



AIRPORTS

AWL 864/BC | PART NO

BEACON 20/55V DC	51016
BEACON 240V AC	51017
FLAT MOUNTER	51031
SIDE BRACKET	51030

MEDIUM INTENSITY AIRCRAFT WARNING LIGHT

Medium intensity aircraft warning light engineered according to ICAO Medium Intensity Type B/C and FAA L-864 regulations.

With an induced air heatsink base, this device is the ideal solution for an efficient and long lasting quality obstruction beacon.

Provided with a steady/flashing red light, its optical lenses guarantee a 360° horizontal beam radiation and a vertical beam of +3°. Can be configured to Type B (flashing) or Type C (steady).

The LED circuit guarantees a long product life estimated in over 10 years, as well as low consumption (1/10 when compared to xenon discharge bulbs).

The device is equipped with three spirit balls for perfect installation and can send an alarm signal in case of malfunction.

KEY CHARACTERISTICS

LED technology

Product life >10 years

Low consumption

Stabilized light output

INSTALLATION

Flat mounting | To flat surfaces using the accessory "Flat mouter"

Side mounting | To side walls, side poles or side structures using the accessory "Side bracket"

DRAWINGS, DIMENSIONS AND WEIGHTS

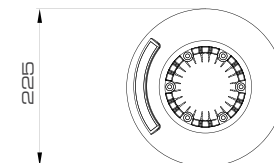
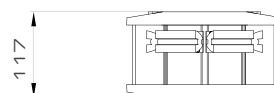

ICARO



**TWIN
BACK-UP
CIRCUIT
INCLUDED**

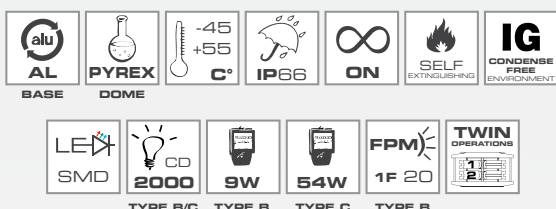

CERTIFICATIONS



ICAO International Standards and Recommended Practices:
Aerodromes - Annex 14 Volume 1, 4th Edition, November 2004
Chapter 6

FAA Advisor Circular AC150/5345-43F

TYPICAL APPLICATIONS

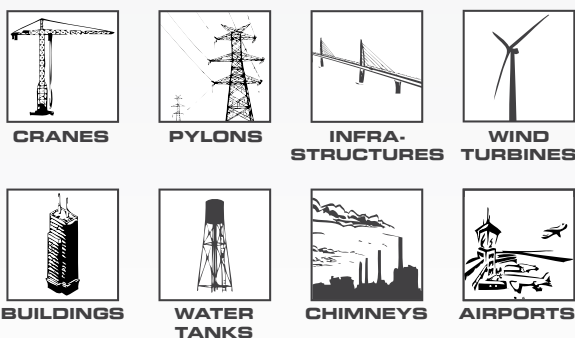

AWL 864/BC TWIN | PART NO

BEACON 20/55V DC	51018
BEACON 240V AC	51019
FLAT MOUNTER	51031
SIDE BRACKET	51030

TWIN MEDIUM INTENSITY AIRCRAFT WARNING LIGHT

Medium intensity aircraft warning light engineered according to ICAO Medium Intensity Type B/C and FAA L-864 regulations.

With an induced air heatsink base, this device is the ideal solution for an efficient and long lasting quality obstruction beacon.

Provided with a steady/flashing red light, its optical lenses guarantee a 360° horizontal beam radiation and a vertical beam of +3°. Can be configured to Type B (flashing) or Type C (steady).

The LED circuit guarantees a long product life estimated in over 10 years, as well as low consumption (1/10 when compared to xenon discharge bulbs).

The device is equipped with two separate LED circuits and, thanks to the current sensor installed on board, it automatically switches to the secondary circuit when main fails, with the possibility of sending an alarm signal.

The device is equipped with three spirit balls for perfect installation and can send an alarm signal in case of malfunction.

KEY CHARACTERISTICS

LED technology

Product life >10 years

Low consumption

Stabilized light output

Twin operations with the same device
(back-up circuit included)

INSTALLATION

Flat mounting | To flat surfaces using the accessory "Flat mouter"

Side mounting | To side walls, side poles or side structures using the accessory "Side bracket"

DRAWINGS, DIMENSIONS AND WEIGHTS

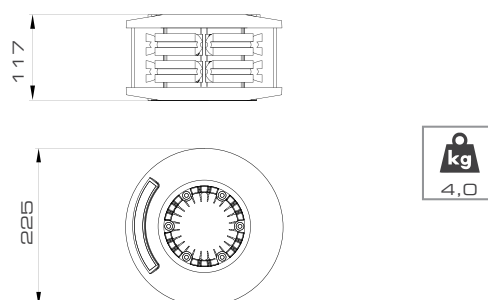

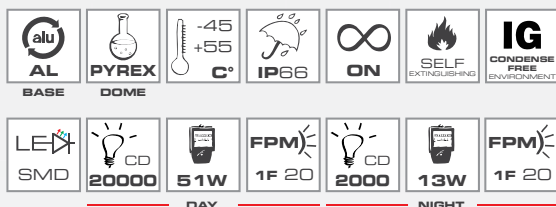

CERTIFICATIONS



ICAO International Standards and Recommended Practices:
Aerodromes - Annex 14 Volume 1, 4th Edition, November 2004
Chapter 6

FAA Advisor Circular AC150/5345-43F

TYPICAL APPLICATIONS

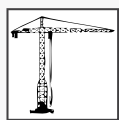

CRANES



PYLONS

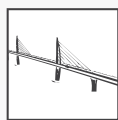

INFRA-
STRUCTURES



WIND
TURBINES



BUILDINGS



WATER
TANKS



CHIMNEYS



AIRPORTS

AWL 865.866/A | PART NO

BEACON 20/55V DC	51020
BEACON 240V AC	51021
FLAT MOUNTER	51031
SIDE BRACKET	51030

MEDIUM INTENSITY AIRCRAFT WARNING LIGHT

Medium intensity aircraft warning light engineered according to ICAO Medium Intensity Type A and FAA L-865/L-866 regulations.

With an induced air heatsink base, this device is the ideal solution for an efficient and long lasting quality obstruction beacon.

Provided with a flashing white light, its optical lenses guarantee a 360° horizontal beam radiation and a vertical beam of +3°.

The LED circuit guarantees a long product life estimated in over 10 years, as well as low consumption (1/10 when compared to xenon discharge bulbs).

The device is equipped with three spirit balls for perfect installation and can send an alarm signal in case of malfunctioning.

KEY CHARACTERISTICS

LED technology

Product life >10 years

Low consumption

Stabilized light output

INSTALLATION

Flat mounting | To flat surfaces using the accessory "Flat mounter"

Side mounting | To side walls, side poles or side structures using the accessory "Side bracket"

DRAWINGS, DIMENSIONS AND WEIGHTS

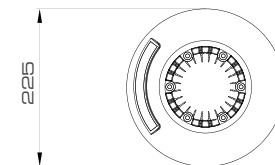

ICARO



**DUAL
TYPE A +
TYPE BC**



TYPE A			
LED SMD	CD 20000	51W	FPM 1F 20
DAY			
TYPE BC			
CD 2000	9W	54W	FPM 1F 20
TYPE B/C	TYPE B	TYPE C	TYPE B

CERTIFICATIONS



ICAO International Standards and Recommended Practices:
Aerodromes - Annex 14 Volume 1, 4th Edition, November 2004
Chapter 6

FAA Advisor Circular AC150/5345-43F

TYPICAL APPLICATIONS

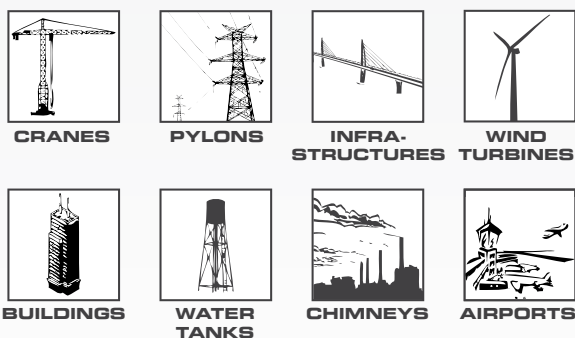

AWL 864+865.866/BC+A | PART NO

BEACON 20/55V DC	51022
BEACON 240V AC	51023
FLAT MOUNTER	51031
SIDE BRACKET	51030

DUAL MEDIUM INTENSITY AIRCRAFT WARNING LIGHT

Medium intensity aircraft warning light engineered according to ICAO Medium Intensity Type A + Type B/C and FAA L-865/L-866 + L-864 regulations.

With an induced air heatsink base, this device is the ideal solution for an efficient and long lasting quality obstruction beacon.

Provided with both a steady/flashing red light (Type BC) and a flashing white light (Type A), its optical lenses guarantee a 360° horizontal beam radiation and a vertical beam of +3°.

The LED circuit guarantees a long product life estimated in over 10 years, as well as low consumption (1/10 when compared to xenon discharge bulbs).

The device is equipped with three spirit balls for perfect installation and can send an alarm signal in case of malfunction.

KEY CHARACTERISTICS

LED technology

Product life >10 years

Low consumption

Stabilized light output

Dual functionality (Type A + Type B/C)

INSTALLATION

Flat mounting | To flat surfaces using the accessory "Flat mouter"

Side mounting | To side walls, side poles or side structures using the accessory "Side bracket"

DRAWINGS, DIMENSIONS AND WEIGHTS

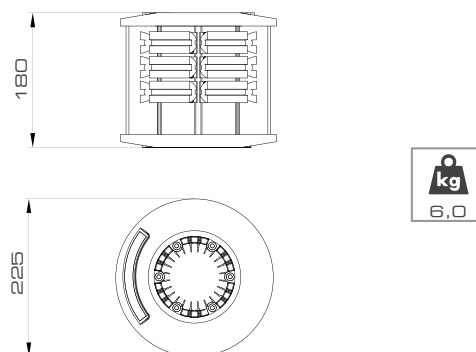

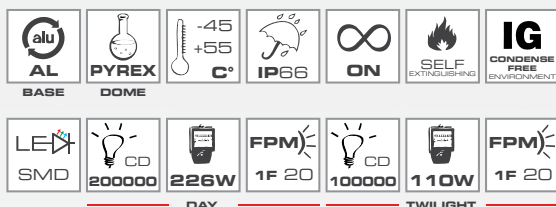

CERTIFICATIONS



ICAO International Standards and Recommended Practices:
Aerodromes - Annex 14 Volume 1, 4th Edition, November 2004
Chapter 6

FAA Advisor Circular AC150/5345-43F

TYPICAL APPLICATIONS

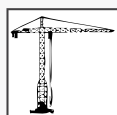

CRANES



PYLONS

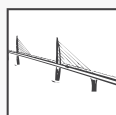

INFRA-
STRUCTURES



WIND
TURBINES



BUILDINGS



WATER
TANKS



CHIMNEYS



AIRPORTS

AWL 856.857/AB | PART NO

BEACON 240V AC (120°)	51024
BEACON 240V AC (360°)	51025
FLAT MOUNTER	51031
SIDE BRACKET	51030

HIGH INTENSITY AIRCRAFT WARNING LIGHT

High intensity aircraft warning light engineered according to ICAO High Intensity Type A/B and FAA L-856/L-857 regulations.

With an induced air heatsink base, this device is the ideal solution for an efficient and long lasting quality obstruction beacon.

Provided with a flashing white light, its optical lenses guarantee a 120°/360° horizontal beam radiation and a vertical beam of +3°/7°. Can be configured to Type A (100.000 Cd twilight use) or Type B (200.000 Cd day use).

The LED circuit guarantees a long product life estimated in over 10 years, as well as low consumption (1/10 when compared to xenon discharge bulbs).

The device is equipped with three spirit balls for perfect installation and can send an alarm signal in case of malfunction.

KEY CHARACTERISTICS

LED technology

Product life >10 years

Low consumption

Stabilized light output

120° or 360° versions available

INSTALLATION

Flat mounting | To flat surfaces using the accessory "Flat mouter"

Side mounting | To side walls, side poles or side structures using the accessory "Side bracket"

DRAWINGS, DIMENSIONS AND WEIGHTS

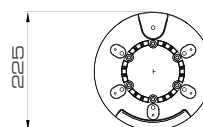
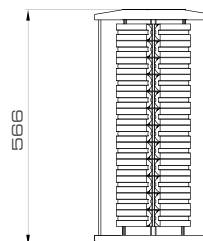

ICARO

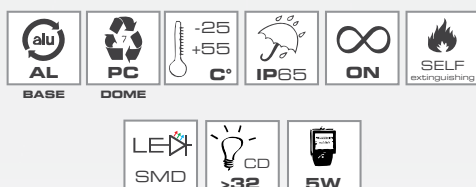

IRRADIATION BEAM

SIDE VIEW
VERTICAL IRRADIATION



HORIZONTAL LIGHT = 10°
VERTICAL LIGHT = 120°

TOP VIEW
HORIZONTAL IRRADIATION



HORIZONTAL LIGHT = 360°
VERTICAL LIGHT = 360°

CERTIFICATIONS



TYPICAL APPLICATIONS



HELIPADS

AWL HELIX | PART NO

BEACON (24V DC)
PSU (110/240V AC)
SIDE BRACKET

51012
51011
51013

LOW INTENSITY HELIPAD PERIMETER LIGHT

Low intensity helipad perimeter light.

With a lightweight heatsink base, this device is the ideal solution for an efficient and long lasting quality perimeter beacon.

Provided with a green steady light, this device has 2 light sources: horizontal and vertical. The horizontal light is equipped with an optical reflector that guarantees a 360° horizontal beam radiation and a vertical beam of +10°. The vertical light has a horizontal beam radiation of 360° and a vertical beam of 120°.

The LED circuit guarantees a long product life estimated in over 10 years, as well as low consumption (1/10 when compared to incandescent bulbs).



KEY CHARACTERISTICS

LED technology

Product life >10 years

Low consumption

Stabilized light output

INSTALLATION

Pole mounting | Direct (3/4" NPT-F)

Side mounting | To side walls, side poles or side structures using the accessory "Side bracket"

DRAWINGS, DIMENSIONS AND WEIGHTS

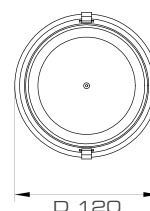
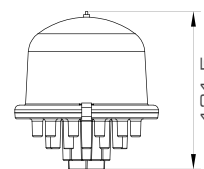

ICARO

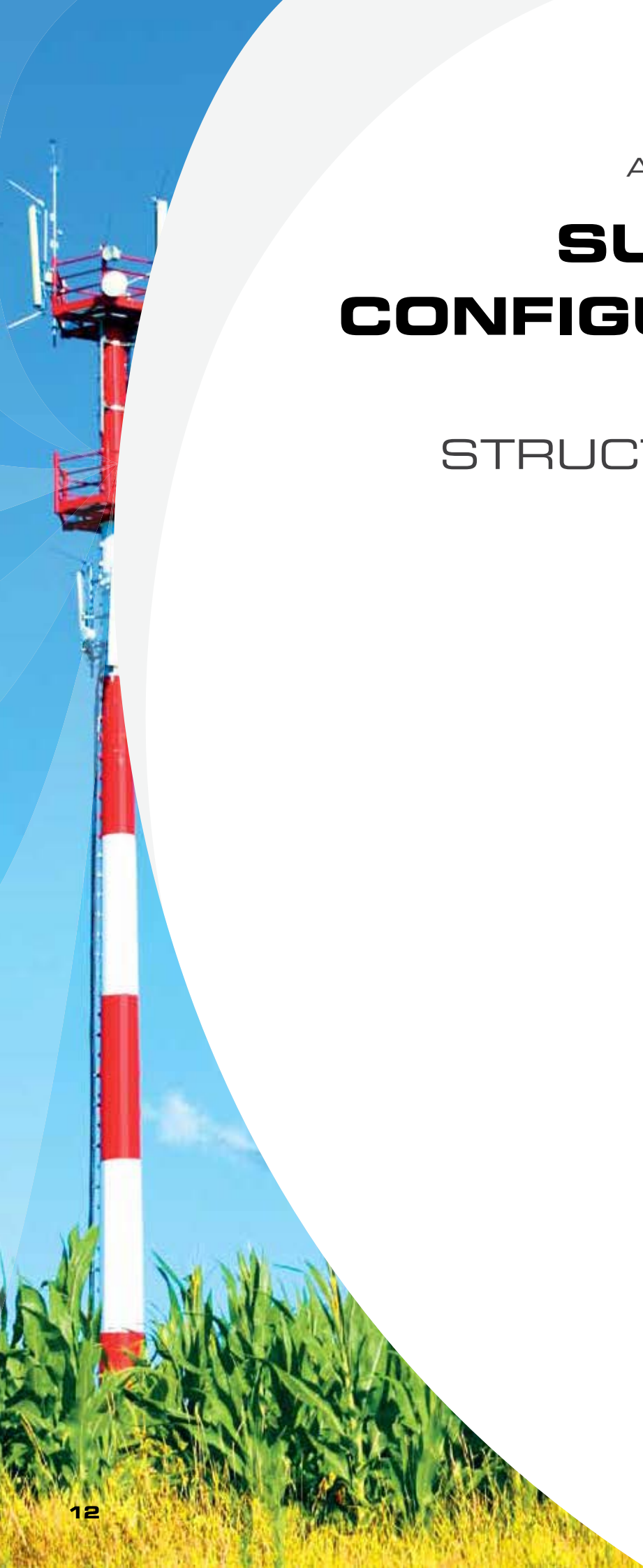

ICARO

Aircraft Warning Lights

SUGGESTED CONFIGURATIONS

ELEVATED
STRUCTURES <45 m

DAY: OFF
NIGHT: STEADY RED

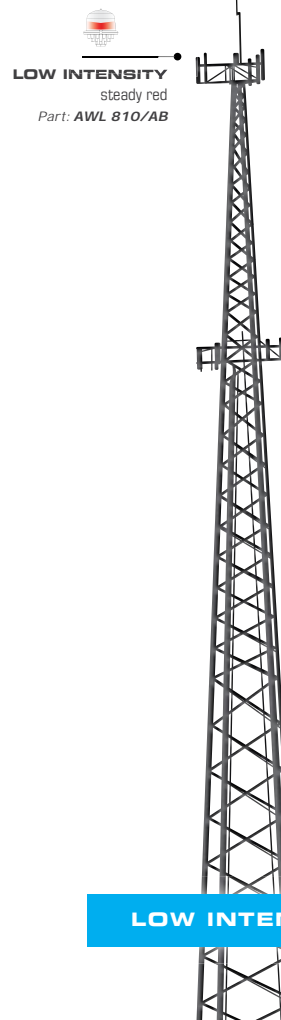

LOW INTENSITY

ELEVATED STRUCTURES <105 m

DAY: FLASHING WHITE
NIGHT: FLASHING WHITE

DAY: FLASHING WHITE
NIGHT: FLASHING RED

DAY: FLASHING WHITE
NIGHT: STEADY RED

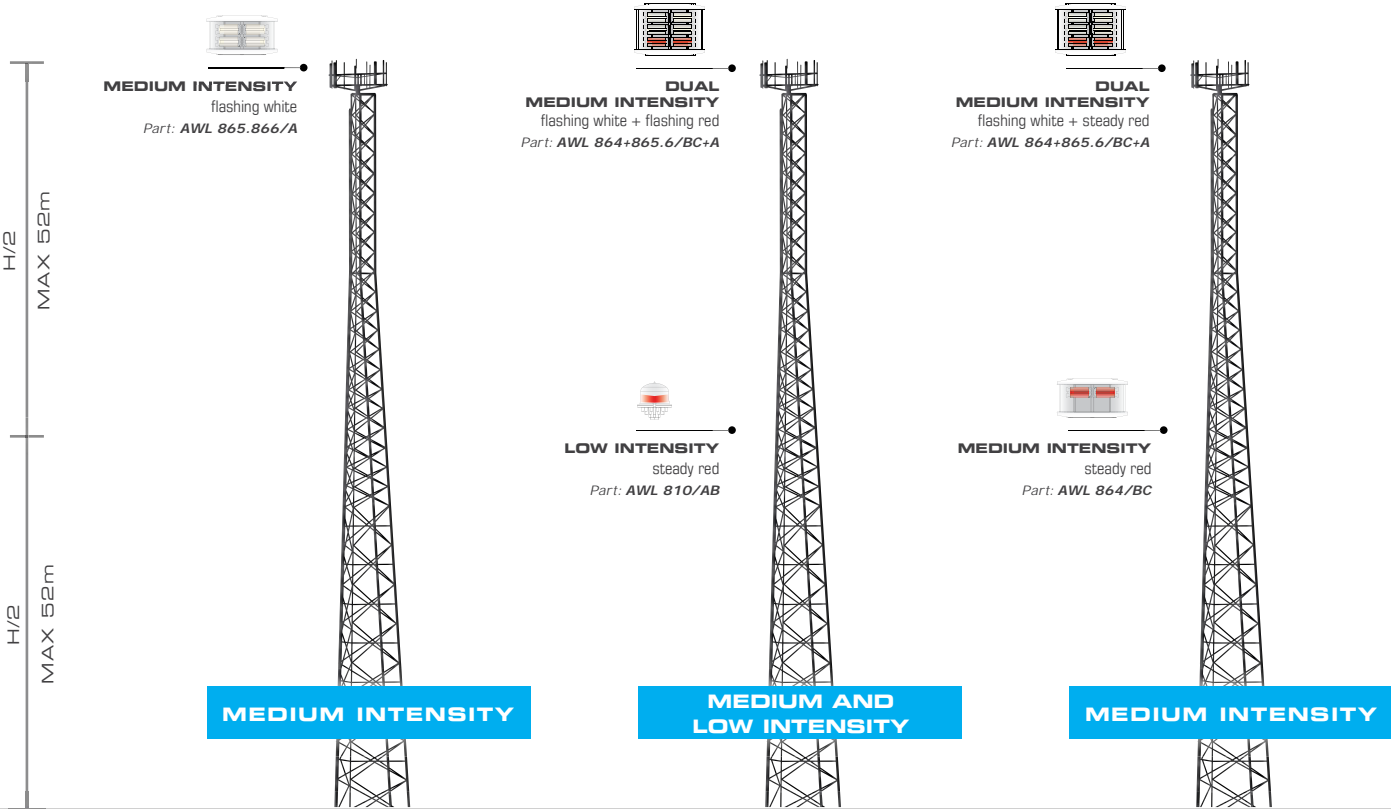

NOT MARKED

DAY: OFF
NIGHT: FLASHING RED

DAY: OFF
NIGHT: STEADY RED

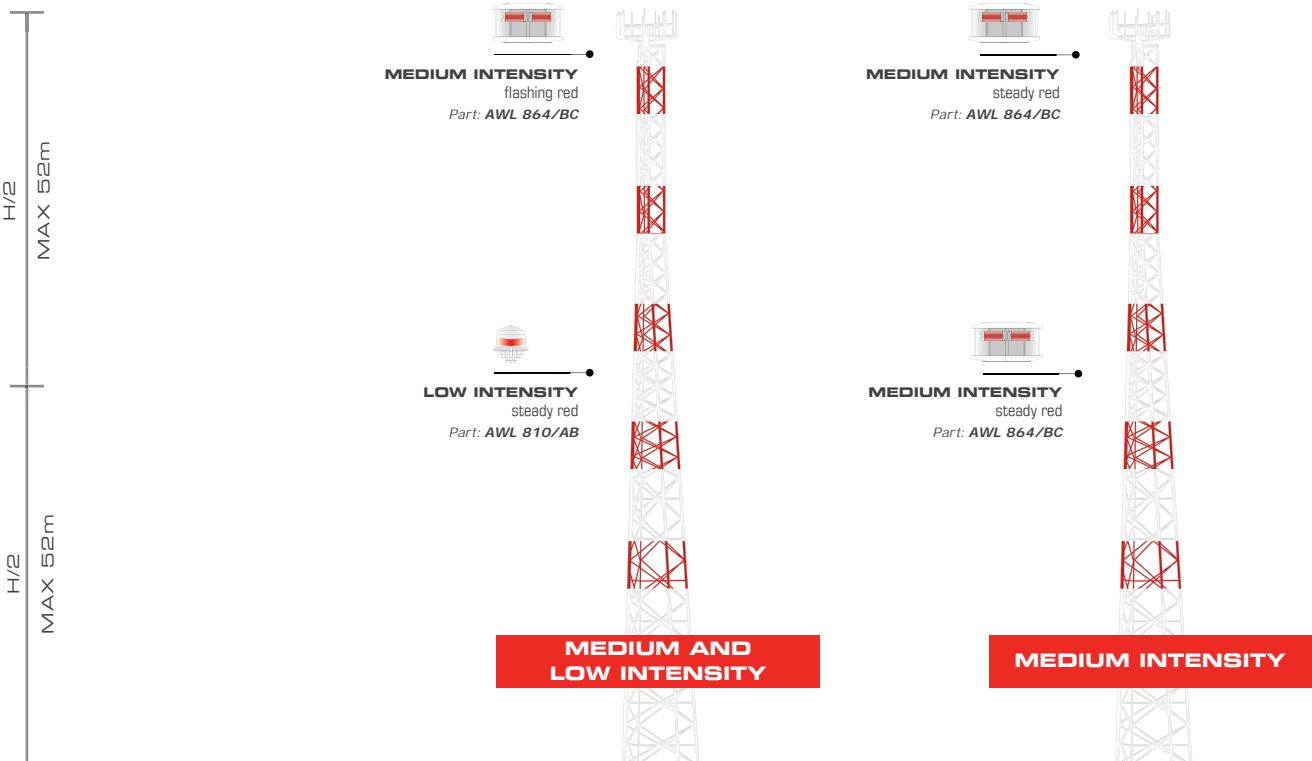

MARKED

ELEVATED STRUCTURES <150 m

DAY: FLASHING WHITE
NIGHT: FLASHING WHITE

DAY: FLASHING WHITE
NIGHT: FLASHING RED

DAY: FLASHING WHITE
NIGHT: STEADY RED

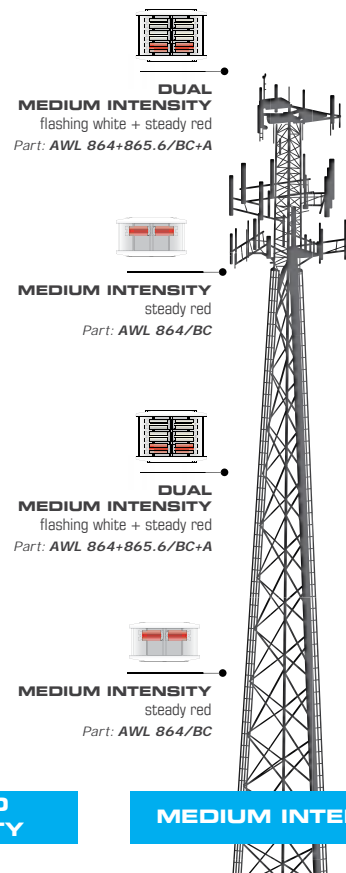
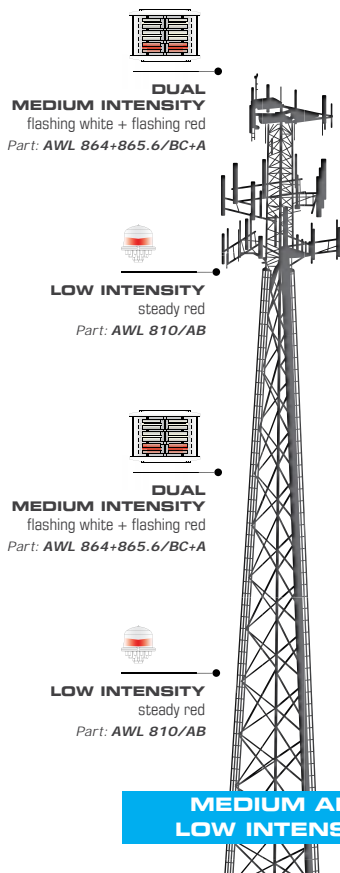
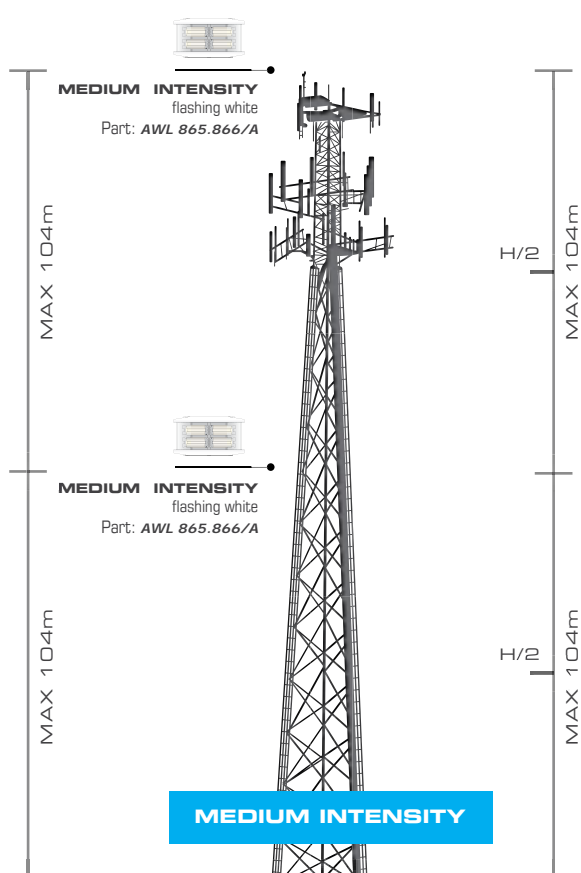

NOT MARKED

DAY: OFF
NIGHT: FLASHING RED

DAY: OFF
NIGHT: STEADY RED

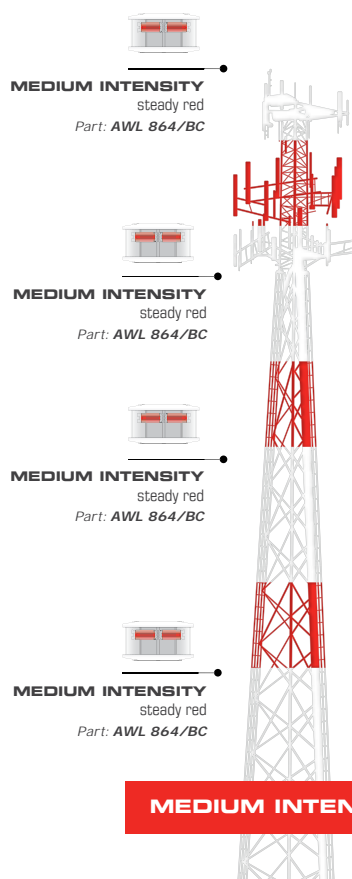
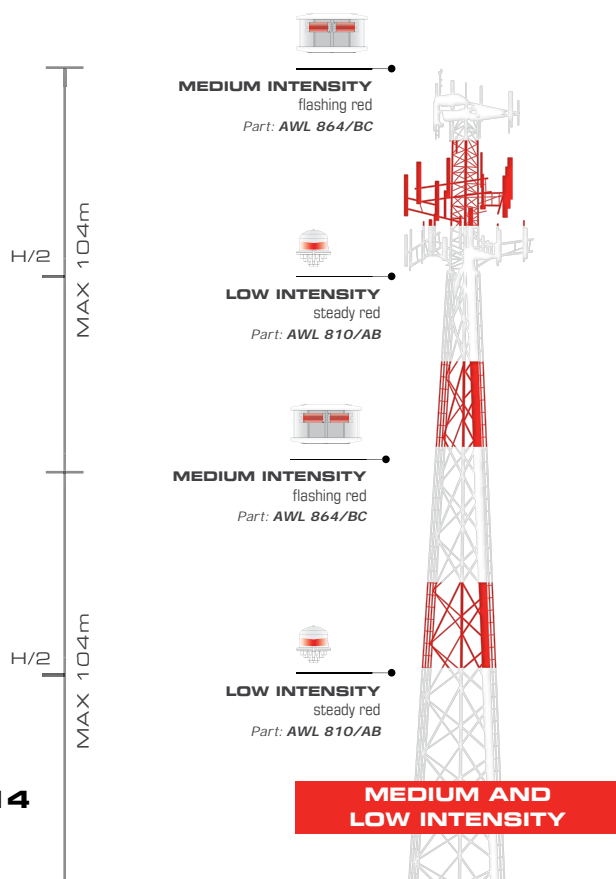

MARKED

ELEVATED STRUCTURES >150 m

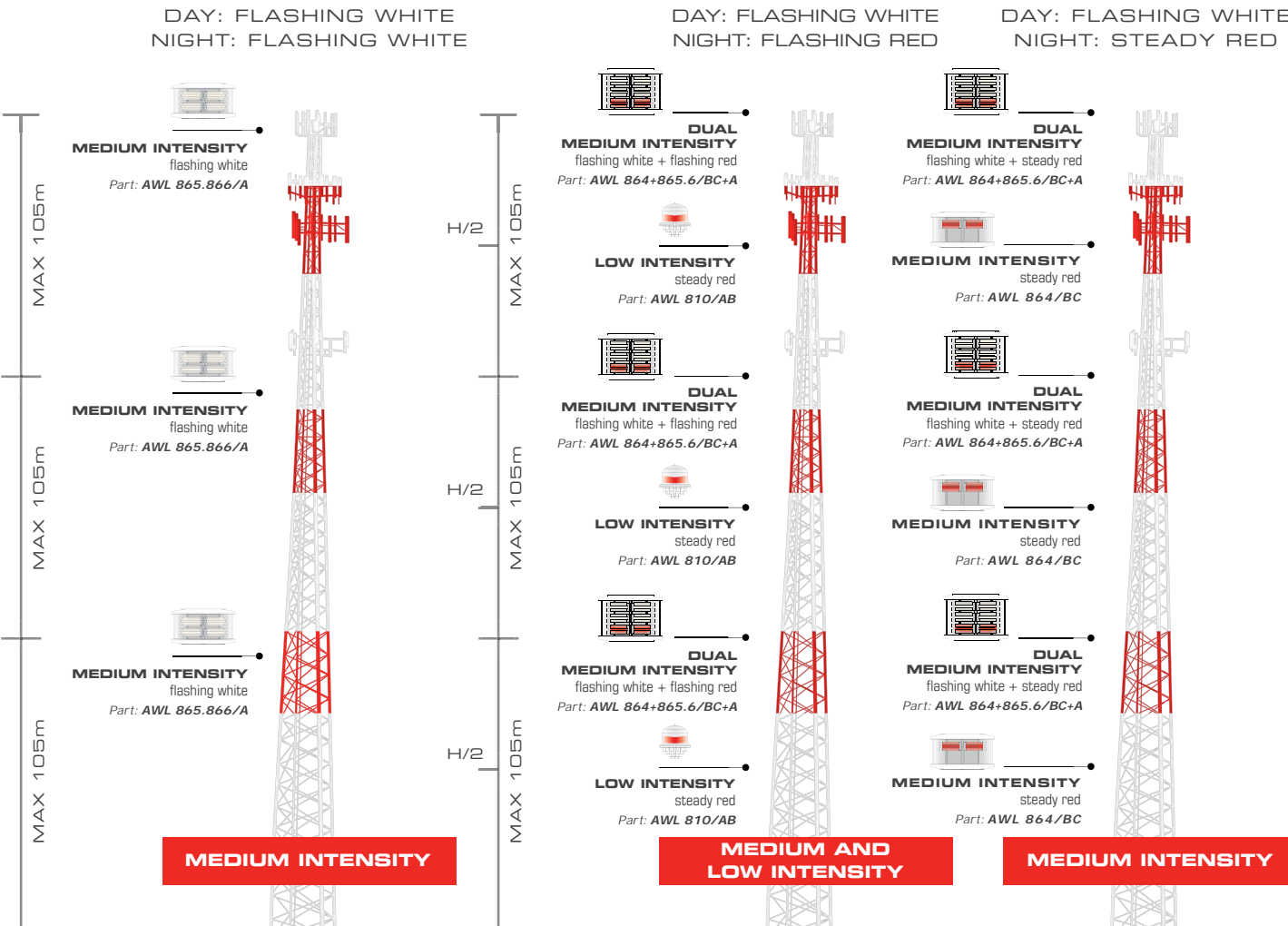
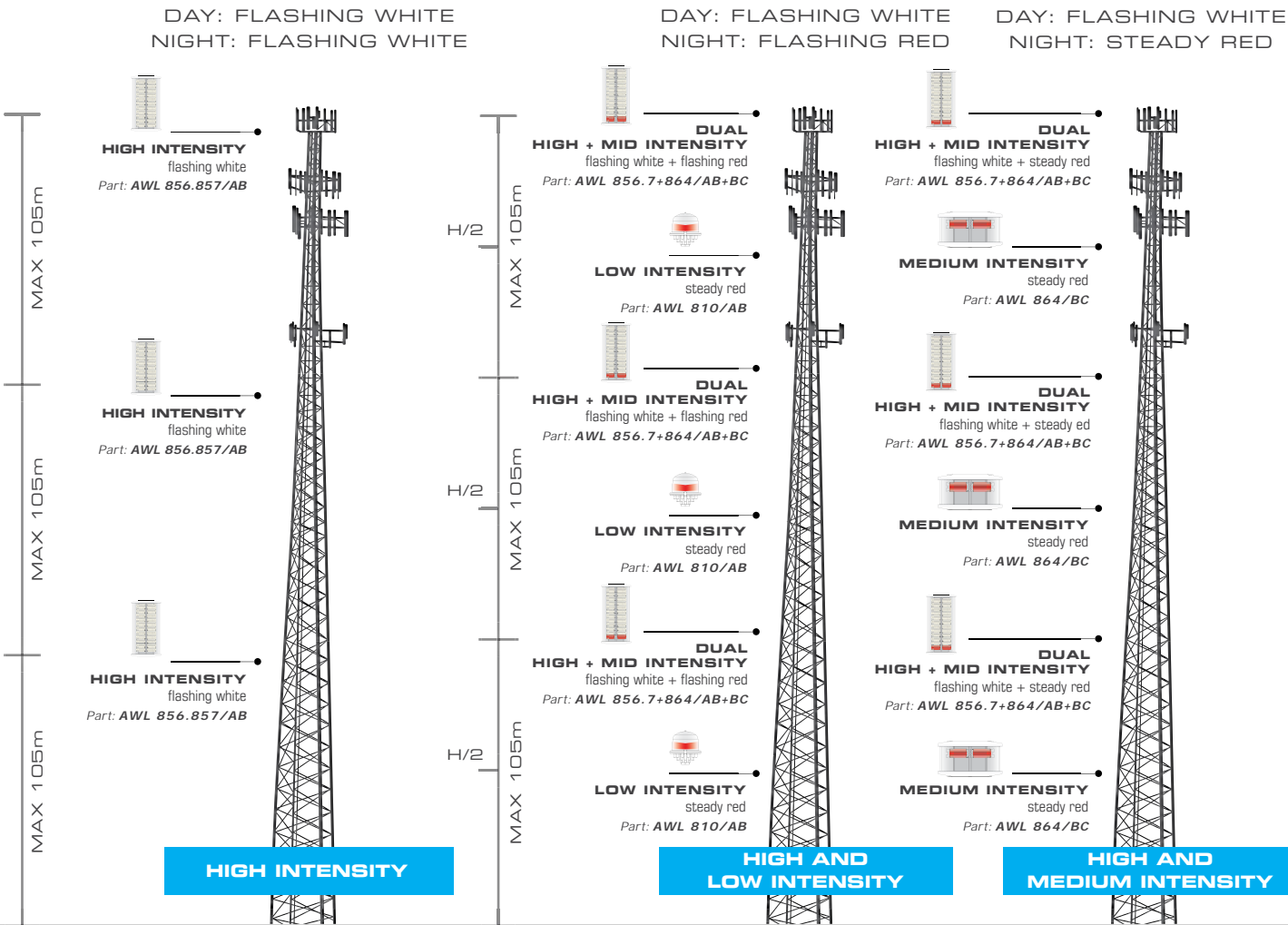

NOT MARKED

MARKED



2 MOUNTERS INCLUDED

AWL 86X/85X FLAT MOUNTER
(includes 2 mounters)

51031



AWL 810/HELIX
(low intensity)



AWL 86X/85X
(medium + high intensity)

AWL 810/HELIX SIDE BRACKET
AWL 86X/85X SIDE BRACKET

51013
51030



AWL 810/HELIX PSU

51011



AWL GPS SYNC MODULE

51032

FLAT MOUNTER

Stainless steel flat mounter, can be used to mount Medium Intensity and High Intensity AWL to flat surfaces



SIDE BRACKETS

Allows lateral mounting to walls, side poles or side structures. Available for AWL 810/HELIX (Low Intensity AWL) and for AWL 86X/85X (Medium and High Intensity AWL)

810/HELIX

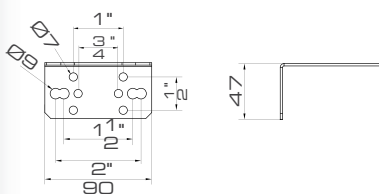

86X/85X

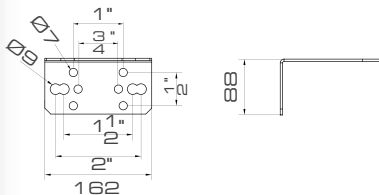

AWL 810/HELIX PSU

110/240V AC Power Supply Unit for AWL 810 and HELIX devices

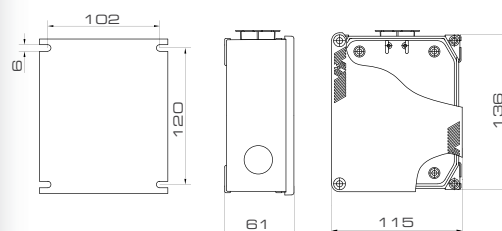

AWL GPS SYNCRONISATION MODULE

Synchronisation module, allows synchronous and catenary flashing via GPS signal wirelessly

ICARO

ICARO

Aircraft Warning Lights

OUR **CONFIGURATOR APPLICATION**

WILL GUIDE YOU TO SELECT
THE BEST AWL SOLUTION
FOR YOUR OBSTACLE
MARKING NEEDS.



ICARO is Sirena's range of high-end
Aircraft Warning Lights engineered
to last and perform

icaro@sirena.it

www.icaroawl.com



MADE IN ITALY
Engineered,
Developed and
Assembled in
Rosta, Italy

SIRENA spa

C.so Moncalisio 5-10-12-14-16
10080 ROSTA (TO) | Italia

Tel: +39.011.95.68.555 (25 lines, ISDN) | Fax
+39.011.95.67.928
www.sirena.it | sirena.spa@sirena.it

R.E.A. 487901 | Merc. TO 027549
Registro Imprese TO - C.F. 01047730013
Partita IVA IT 01047730013
Capitale sociale 5.000.000 di cui versato 5.000.000

